



# Swing Check Valve

Resilient Seated Flanged Ends

Valve Model FCF01



**Fireguard** Check Valve is a compact, rugged swing-type unit providing water flow in one direction and preventing flow in the opposite direction. It is manufactured with a ductile iron body, with clapper assembly for sizes 2 to 12 inch. Designed to minimize water hammer caused by flow reversal, the valve is furnished with flanged or grooved ends for installation.

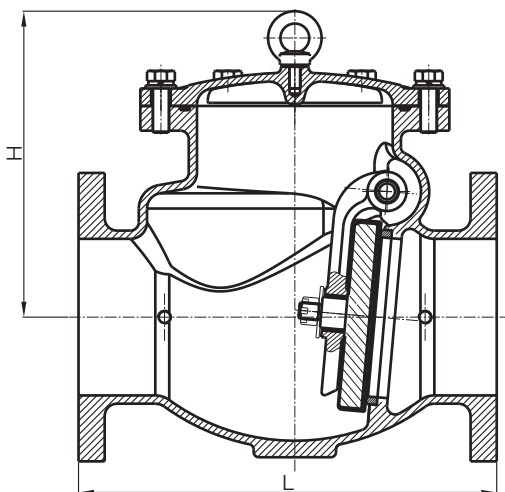

## • Features

Can be installed horizontally or vertically (with upward flow)  
 Convenient to install and maintain  
 Low pressure drop

## • Valve Standard

Conforms to AWWA C508, Clear Waterway

## • Working pressure 300PSI

## • Flanged Ends

ANSI B16.1 Class125/150/250,  
 EN1092-2 PN10/PN16/PN25  
 BS10 Table D/Table E

## • Temperature Range: 0°C-100°C

Coating: Fusion Bonded Epoxy Coating  
 in accordance with ANSI/AWWA C550

## Materials List

Part Name	Material	Specification
Body	Ductile Iron	ASTM A536 65-45-12
Cover	Ductile Iron	ASTM A536 65-45-12
Clapper	Carbon Steel	A36+SS304+EPDM
Clapper Arm	Ductile Iron	ASTM A536 65-45-12
Hinge Pin	Stainless Steel	AISI 304
Seat	Bronze	ASTM C84400
Gasket	EPDM Rubber	

## Dimensions(mm/inch)

SIZE	mm	50	65	80	100	125	150	200	250	300
	inch	2	2½	3	4	5	6	8	10	12
L	mm	203	254	279	330	356	406	495	559	660
	inch	8	10	11	13	14	16	19.5	22	26
H	mm	117	128	132.5	222.5	290	297	365	417.5	453
	inch	4.61	5.04	5.22	8.76	11.42	11.69	14.37	16.44	17.83

## FIREGUARD GLOBAL LTD.

Tel: 00-44-8450751042 • Fax: 00-44-8459751043

Email: Info@Fireguard-Uk.com • www.fireguard-Uk.com

Unit 11 • Chancel Industrial Estate • Newhall Street  
 Willenhall • WV13 1NX • United Kingdom



FS546607



## Resilient Seated Grooved Ends

Valve Model FCG01

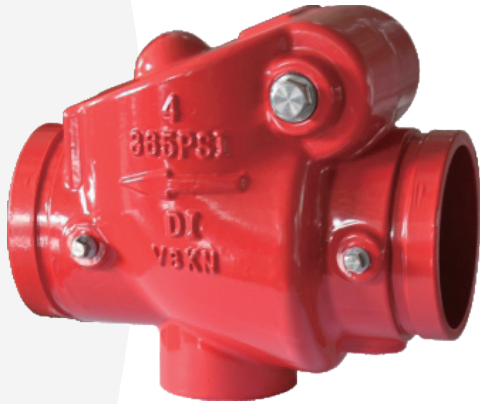

• Valve Standard  
Conforms to AWWA C508, Clear Waterway

• Working pressure 300PSI

Connection Ends  
AWWA C 606  
VDS2100/AS2638.2

• Temperature Range: 0°C-100°C  
Coating: Fusion Bonded Epoxy Coating  
in accordance with ANSI/AWWA C550

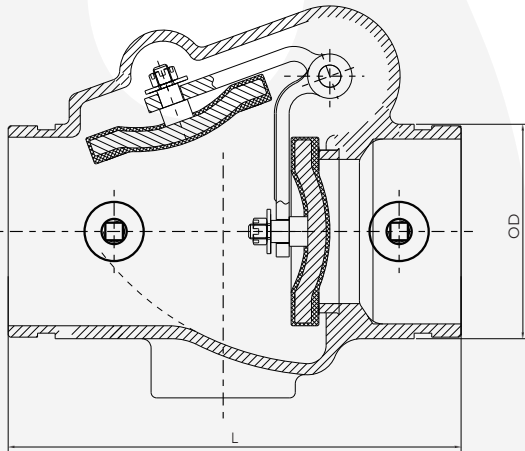

### Materials List

Part Name	Material	Specification
Body	Ductile Iron	ASTM A536 65-45-12
Seat	Bronze	ASTM B62 C83600
Clapper	Q235+SS304+EPDM	
Clapper Arm	Stainless Steel	ASTM A351 CF8
Washer	Stainless Steel	AISI 304
Hexagonal Slot Thin Nut	Stainless Steel	AISI 304
Split Pin	Stainless Steel	AISI 304
Gasket	EPDM Rubber	

### Dimensions(mm/inch)

SIZE	mm	50	65	80	100	125	150	200	250	300
	inch	2	2½	3	4	5	6	8	10	12
L	mm	169	203	213	245	267	292	356	432	495
OD	mm	60.3	73.0/76.1	88.9	114.3	139.7/141.3	165.1/168.3	219.1	273	323.85